

# SH69 C024P

## Heavy-Duty Counterbalance Monitor Arm

For Most 17"-49" Monitors



**Large Dual-Screen Setup Blends Robustness and Stylishness.**

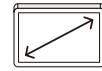
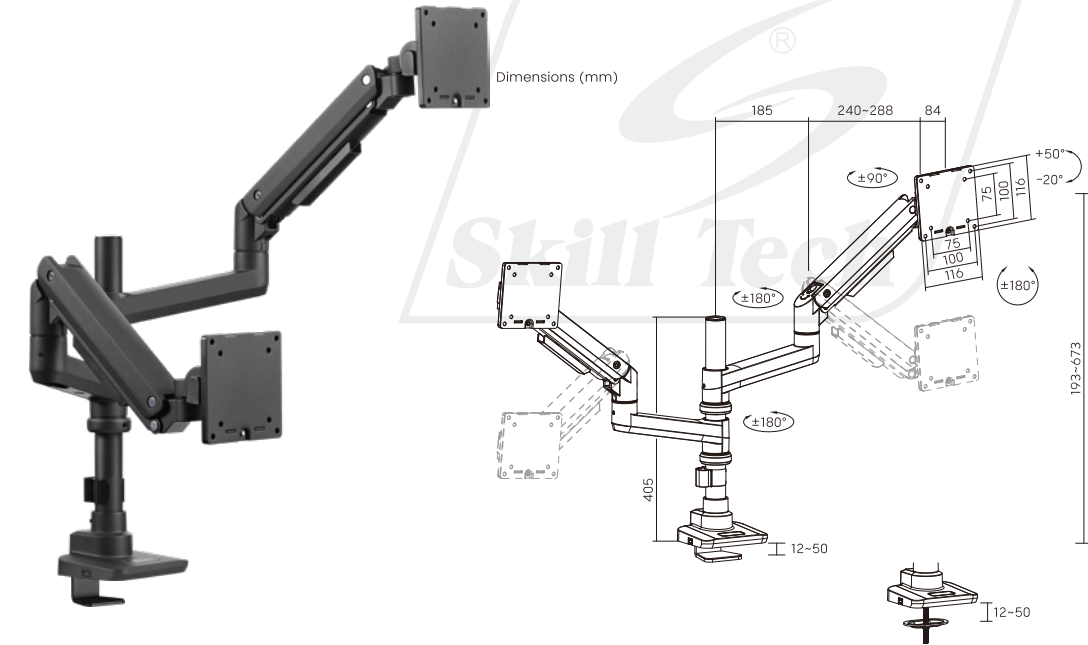

Screen Size  
17"-49"

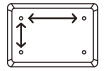

VESA Compatible  
75x75 100x100



Weight Capacity  
2-20kg/4.4-44lbs x2



Screen Rotation  
+180°--180°



Tilt Range  
+50° - -20°

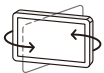

Swivel Range  
+90° - -90°

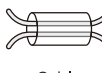

Cable Management

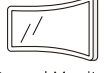

Curved Monitor

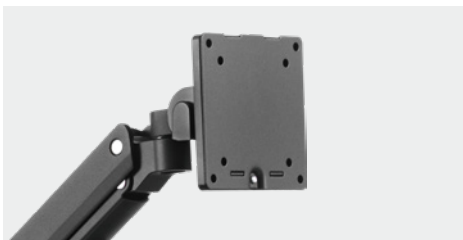

**Quick-Release VESA Plate**  
allows easy installation and removal



**Optimized head tilting structure**  
ensures smoother adjustment



**Easy topside installation needs**  
no more crawling under desks